



欧标法兰参数系列

EN 1092-1:2007 PN6.....	71-72
EN 1092-1:2007 PN10.....	73-74
EN 1092-1:2007 PN16.....	75-76
EN 1092-1:2007 PN25.....	77-78
EN 1092-1:2007 PN40.....	79-80

EN 1092-1:2007

DIMENSIONS OF PN6 FLANGES

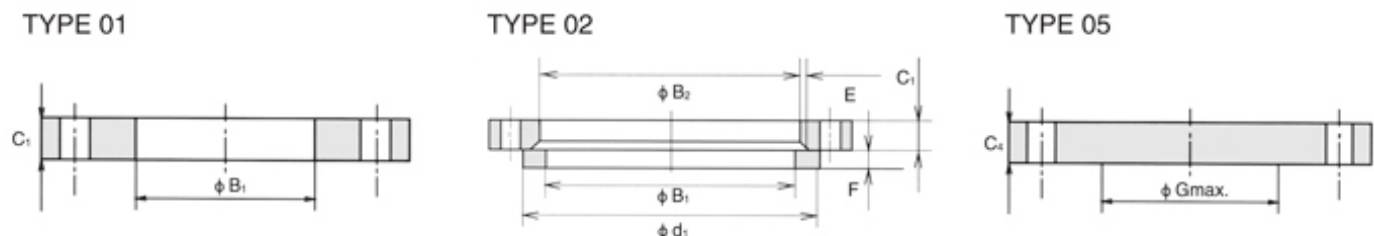

DN	Outside diameter	Diameter of bolt circle	Diameter of bolt hole	Bolt number	Outside diameter of neck A	Bore diameters		Flange thickness			Chamfer E	Wall thickness S	Collar thickness F	Diameter of shoulder Gmax
						B1	B2	C1	C2	C4				
						Flange type								
						01,02,05,11,12,13								
						01 12	02	01 02	11 12,13	05	02	11	32	05
10	75	50	11	4	17.2	18.0	21	12	12	12	3	2	10	-
15	80	55	11	4	21.3	22.0	25	12	12	12	3	2	10	-
20	90	65	11	4	26.9	27.5	31	14	14	14	4	2.3	10	-
25	100	75	11	4	33.7	34.5	38	14	14	14	4	2.6	10	-
32	120	90	14	4	42.4	43.5	46	16	14	14	5	2.6	10	-
40	130	100	14	4	48.3	49.5	53	16	14	14	5	2.6	10	-
50	140	110	14	4	60.3	61.5	65	16	14	14	5	2.9	12	-
65	160	130	14	4	76.1	77.5	81	16	14	14	6	2.9	12	55
80	190	150	18	4	88.9	90.5	94	18	16	16	6	3.2	12	70
100	210	170	18	4	114.3	116.0	120	18	16	16	6	3.6	14	90
125	240	200	18	8	139.7	141.5	145	20	18	18	6	4.0	14	115
150	265	225	18	8	168.3	170.5	174	20	18	18	6	4.5	14	140
200	320	280	18	8	219.1	221.5	226	22	20	20	6	6.3	16	190
250	375	335	18	12	273.0	276.5	281	24	22	22	8	6.3	18	235
300	440	395	22	12	323.9	327.5	333	24	22	22	8	7.1	18	285
350	490	445	22	12	355.6	359.5	365	26	22	22	8	7.1	18	330
400	540	495	22	16	406.4	411.0	416	28	22	22	8	7.1	20	380
450	595	550	22	16	457.0	462.0	467	30	22	24	8	7.1	20	425
500	645	600	22	20	508.0	513.5	519	30	24	24	8	7.1	22	475
600	755	705	26	20	610.0	616.5	622	32	30	30	8	7.1	22	575
700	860	810	26	24	711.0		721	40	30	40	4	8	-	670
800	975	920	30	24	813.0		824	44	30	44	4	8	-	770
900	1075	1020	30	24	914.0		926	48	34	48	4	8	-	860
1000	1175	1120	30	28	1016.0		1028	52	38	52	4	8	-	960
1200	1405	1340	33	32	1219.0		1234	60	42	60	5	8.8	-	1160
1400	1630	1560	36	36	1422		-	72	56	68	-	8.8	-	1346
1600	1830	1760	36	40	1626		-	80	63	76	-	10	-	1546
1800	2045	1970	39	44	1829		-	88	69	84	-	11	-	1746
2000	2265	2180	42	48	2032		-	96	74	92	-	12.5	-	1950

EN 1092-1:2007

DIMENSIONS OF PN6 FLANGES

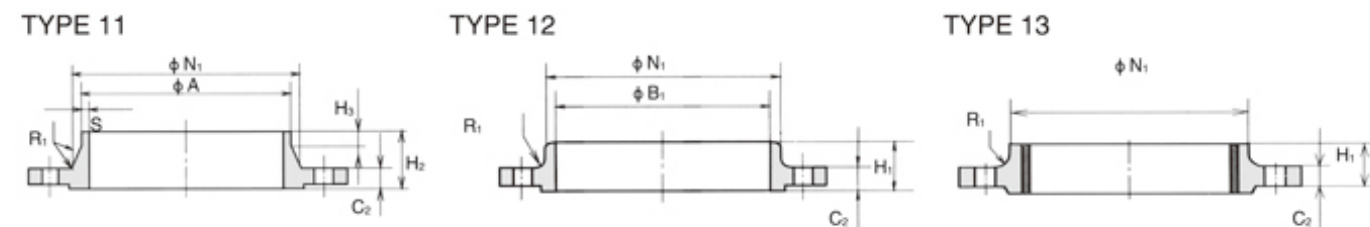

DN	Raised face		Length			Neck diameters		Corner radii	APPROXIMATE WEIGHT				
	d1	f1	H1	H2	H3	N1	N2	R1					
	Flange type												
	01,05,11,12,13			12 13	11	11	11	12 13	11 12,13	Type01	Type02	Type05	Type11
10	35	2	20	28	6	26	25	4	0.356	0.345	0.38	0.353	0.326
15	40	2	20	30	6	30	30	4	0.402	0.388	0.438	0.408	0.373
20	50	2	24	32	6	38	40	4	0.592	0.568	0.657	0.621	0.584
25	60	2	24	35	6	42	50	4	0.719	0.688	0.821	0.762	0.729
32	70	2	26	35	6	55	60	6	1.16	1.12	1.18	1.11	1.04
40	80	3	26	38	7	62	70	6	1.35	1.29	1.39	1.26	1.20
50	90	3	28	38	8	74	80	6	1.48	1.42	1.62	1.43	1.34
65	110	3	32	38	9	88	100	6	1.86	1.76	2.14	1.77	1.83
80	128	3	34	42	10	102	110	8	2.95	2.84	3.43	2.88	2.75
100	148	3	40	45	10	130	130	8	3.26	3.10	4.22	3.41	3.01
125	178	3	44	48	10	155	160	8	4.31	4.12	6.10	4.65	4.30
150	202	3	44	48	12	184	185	10	4.76	4.53	7.51	5.50	4.63
200	258	3	44	55	15	236	240	10	6.88	6.51	12.3	8.60	6.97
250	312	3	44	60	15	290	295	12	8.92	8.32	18.5	11.7	9.13
300	365	4	44	62	15	342	355	12	11.9	11.1	25.5	15.3	12.4
350	415	4	-	62	15	385	-	12	16.8	15.9	31.8	20.3	-
400	465	4	-	65	15	438	-	12	19.8	18.8	38.5	23.1	-
450	520	4	-	65	15	492	-	12	24.6	23.3	51.2	27.0	-
500	570	4	-	68	15	538	-	12	26.4	24.9	60.1	30.8	-
600	670	5	-	70	16	640	-	12	34.8	33.0	103	44.0	-
700	775	5	-	76	16	740	-	12	-	-	178	53.7	-
800	880	5	-	76	16	842	-	12	-	-	252	64.4	-
900	980	5	-	78	16	942	-	12	-	-	336	79.2	-
1000	1080	5	-	82	16	1045	-	16	-	-	435	98.6	-
1200	1295	5	-	104	20	1248	-	16	-	-	717	152	-
1400	1510	5	-	114	20	1452	-	16	-	-	1094	246	-
1600	1710	5	-	119	20	1655	-	16	-	-	1545	309	-
1800	1920	5	-	133	20	1855	-	16	-	-	2131	400	-
2000	2125	5	-	146	25	2058	-	16	-	-	2862	516	-

EN 1092-1:2007

DIMENSIONS OF PN10 FLANGES

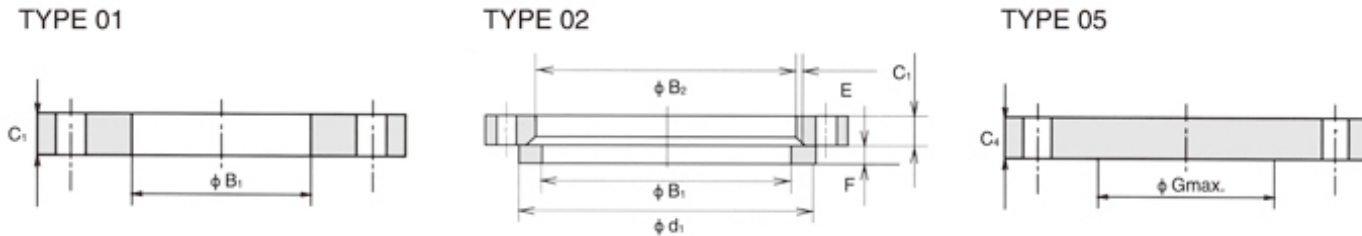

DN	Outside diameter	Diameter of bolt circle	Diameter of bolt hole	Bolt number	Outside diameter of neck A	Bore diameters		Flange thickness			Chamfer E	Wall thickness S	Collar Thickness F	Diameter of shoulder Gmax
						B1	B2	C1	C2	C4				
						Flange type								
01,02,05,11,12,13					11	01 12	02	01 02	11 12,13	05	02	11	32	05
10	90	60	14	4	17.2	18.0	21	14	16	16	3	2	12	-
15	95	65	14	4	21.3	22.0	25	14	16	16	3	2	12	-
20	105	75	14	4	26.9	27.5	31	16	18	18	4	2.3	14	-
25	115	85	14	4	33.7	34.5	38	16	18	18	4	2.6	14	-
32	140	100	18	4	42.4	43.5	47	18	18	18	5	2.6	14	-
40	150	110	18	4	48.3	49.5	53	18	18	18	5	2.6	14	-
50	165	125	18	4	60.3	61.5	65	20	18	18	5	2.9	16	-
65	185	145	18	8	76.1	77.5	81	20	18	18	6	2.9	16	55
80	200	160	18	8	88.9	90.5	94	20	20	20	6	3.2	16	70
100	220	180	18	8	114.3	116.0	120	22	20	20	6	3.6	18	90
125	250	210	18	8	139.7	141.5	145	22	22	22	6	4.0	18	115
150	285	240	22	8	168.3	170.5	174	24	22	22	6	4.5	20	140
200	340	295	22	8	219.1	221.5	226	24	24	24	6	6.3	20	190
250	395	350	22	12	273.0	276.5	281	26	26	26	8	6.3	22	235
300	445	400	22	12	323.9	327.5	333	26	26	26	8	7.1	22	285
350	505	460	22	16	355.6	359.5	365	30	26	26	8	7.1	22	330
400	565	515	26	16	406.4	411.0	416	32	26	26	8	7.1	24	380
450	615	565	26	20	457.0	462.0	467	36	28	28	8	7.1	24	425
500	670	620	26	20	508.0	513.5	519	38	28	28	8	7.1	26	475
600	780	725	30	20	610.0	616.5	622	42	30	34	8	8.0	26	575
700	895	840	30	24	711.0		721	50	35	38	8	8.8	-	670
800	1015	950	33	24	813.0		824	56	38	48	8	8.8	-	770
900	1115	1050	33	28	914.0		926	62	38	50	8	12.5	-	860
1000	1230	1160	36	28	1016.0		1028	70	44	54	8	12.5	-	960
1200	1455	1380	39	32	1219.0		1234	83	55	66	8	12.5	-	1160
1400	1675	1590	42	36	1422		-	-	65	-	-	14.2	-	-
1600	1915	1820	48	40	1626		-	-	75	-	-	16	-	-
1800	2115	2020	48	44	1829		-	-	85	-	-	17.5	-	-
2000	2325	2230	48	48	2032		-	-	90	-	-	17.5	-	-

To be specified by the purchaser

EN 1092-1:2007

DIMENSIONS OF PN10 FLANGES

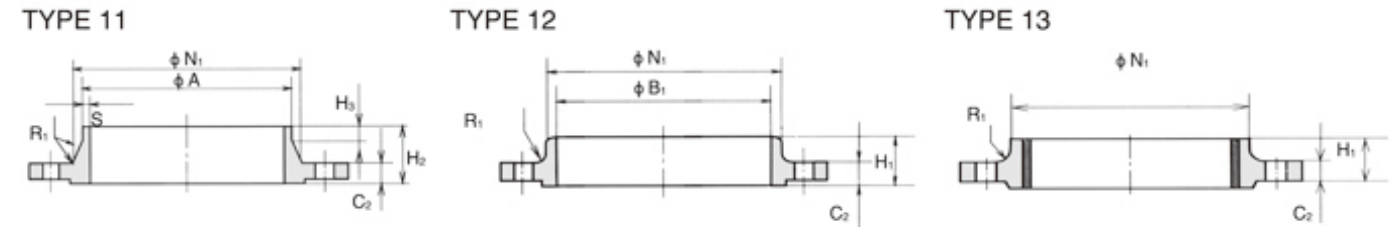

DN	Raised face		Length			Neck diameters		Corner radii R1	APPROXIMATE WEIGHT											
	d1	f1	H1	H2	H3	N1	N2													
	Flange type								Type01	Type02	Type05	Type11	Type12							
									01,05,11,12,13	12 13	11	11	11	12 13	11 12,13					
10	40	2	22	35	6	28	30	4	0.604	0.591	0.722	0.678	0.646							
15	45	2	22	38	6	32	35	4	0.670	0.654	0.813	0.768	0.722							
20	58	2	26	40	6	40	45	4	0.936	0.909	1.14	1.09	1.04							
25	68	2	28	40	6	46	52	4	1.11	1.08	1.38	1.30	1.25							
32	78	2	30	42	6	56	60	6	1.82	1.77	2.03	1.91	1.81							
40	88	3	32	45	7	64	70	6	2.08	2.02	2.35	2.15	2.06							
50	102	3	28	45	8	74	84	6	2.73	2.52	2.88	2.53	2.39							
65	122	3	32	45	10	92	104	6	3.16	3.05	3.51	3.03	2.97							
80	138	3	34	50	10	105	118	6	3.79	3.48	4.61	3.92	3.78							
100	158	3	40	52	12	131	140	8	4.39	4.20	5.65	4.62	4.38							
125	188	3	44	55	12	156	168	8	5.41	5.21	8.13	6.30	6.07							
150	212	3	44	55	12	184	195	10	7.14	6.89	10.5	7.81	7.24							
200	268	3	44	62	16	234	246	10	9.27	8.87	16.5	11.6	10.1							
250	320	3	46	68	16	292	298	12	11.8	11.2	24.1	15.8	12.8							
300	370	4	46	68	16	342	350	12	13.6	12.8	30.8	18.3	14.5							
350	430	4	53	68	16	385	400	12	20.4	19.4	39.6	25.3	22.7							
400	482	4	57	72	16	440	456	12	27.5	26.4	49.4	30.6	28.0							
450	532	4	63	72	16	488	502	12	33.6	32.2	63	35.1	32.3							
500	585	4	67	75	16	542	559	12	40.2	38.5	75.2	40.5	38.7							
600	685	5	75	82	18	642	658	12	54.5	52.2	124	52.9	48.9							
700	800	5	-	85	18	746	-	12	-	79.4	183	75.8	-							
800	905	5	-	96	18	850	-	12	-	112	297	102	-							
900	1005	5	-	99	20	950	-	12	-	135	374	121	-							
1000	1110	5	-	105	20	1052	-	16	-	180	492	161	-							
1200	1330	5	-	132	25	1256	-	16	-	278	842	258	-							
1400	1535	5	-	143	25	1460	-	16	-	-	-	371	-							
1600	1760	5	-	159	25	1666	-	16	-	-	-	547	-							
1800	1960	5	-	175	30	1868	-	16	-	-	-	691	-							
2000	2170	5	-	186	30	2072	-	16	-	-	-	830	-							

EN 1092-1:2007

DIMENSIONS OF PN25 FLANGES

TYPE 01

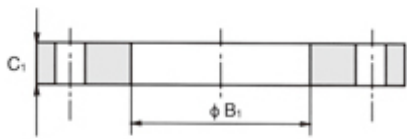

TYPE 02

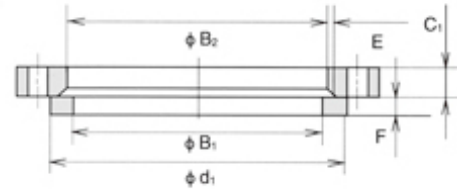

TYPE 05



DN	Outside diameter	Diameter of bolt circle	Diameter of bolt hole	Bolt number	Outside diameter of neck A	Bore diameters		Flange thickness			Chamfer E	Wall thickness S	Collar Thickness F	Diameter of shoulder Gmax
						B ₁	B ₂	C ₁	C ₂	C ₄				
						Flange type								
01,02,05,11,12,13					11	01 12	02	01 02	11 12,13	05	02	11	32	05
10	90	60	14	4	17.2	18.0	21	14	16	16	3	2.0	12	-
15	95	65	14	4	21.3	22.0	25	14	16	16	3	2.0	12	-
20	105	75	14	4	26.9	27.5	31	16	18	18	4	2.3	14	-
25	115	85	14	4	33.7	34.5	38	16	18	18	4	2.6	14	-
32	140	100	18	4	42.4	43.5	47	18	18	18	5	2.6	14	-
40	150	110	18	4	48.3	49.5	53	18	18	18	5	2.6	14	-
50	165	125	18	4	60.3	61.5	65	20	20	20	5	2.9	16	-
65	185	145	18	8	76.1	77.5	81	22	22	22	6	2.9	16	55
80	200	160	18	8	88.9	90.5	94	24	24	24	6	3.2	18	70
100	235	190	22	8	114.3	116.0	120	26	24	24	6	3.6	20	90
125	270	220	26	8	139.7	141.5	145	28	26	26	6	4.0	22	115
150	300	250	26	8	168.3	170.5	174	30	28	28	6	4.5	24	140
200	360	310	26	12	219.1	221.5	226	32	30	30	6	6.3	26	190
250	425	370	30	12	273.0	276.5	281	35	32	32	8	7.1	26	235
300	485	430	30	16	323.9	327.5	333	38	34	34	8	8.0	28	285
350	555	490	33	16	355.6	359.5	365	42	38	38	8	8.0	32	332
400	620	550	36	16	406.4	411.0	416	48	40	40	8	8.8	34	380
450	670	600	36	20	457.0	462.0	467	54	46	50	8	8.8	36	425
500	730	660	36	20	508.0	513.5	519	58	48	51	8	10.0	38	475
600	845	770	39	20	610.0	616.5	622	68	48	66	8	12.5	40	575
700	960	875	42	24	711	-	721	85	50	-	8	14.2	-	-
800	1085	990	48	24	813	-	824	95	53	-	8	16	-	-
900	1185	1090	48	28	914	-	-	-	57	-	-	17.5	-	-
1000	1320	1210	56	28	1016	-	-	-	63	-	-	20	-	-

EN 1092-1:2007

DIMENSIONS OF PN25 FLANGES

TYPE 11

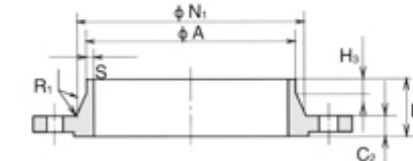

TYPE 12

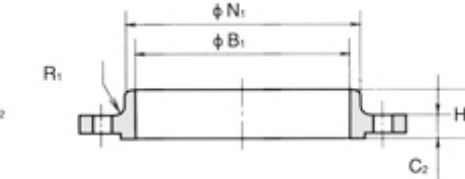

TYPE 13

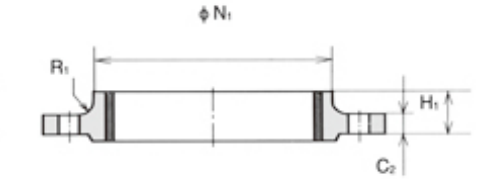

DN	Raised face		Length			Neck diameters		Corner radii	APPROXIMATE WEIGHT				
	d ₁	f ₁	H ₁	H ₂	H ₃	N ₁	N ₂	R ₁					
	Flange type									Type01	Type02	Type05	Type11
01,05,11,12,13			12 13	11	11	11	12 13	11 12,13					
10	40	2	22	35	6	28	30	4	0.604	0.591	0.722	0.678	0.646
15	45	2	22	38	6	32	35	4	0.670	0.654	0.813	0.768	0.722
20	58	2	26	40	6	40	45	4	0.936	0.909	1.14	1.09	1.04
25	68	2	28	40	6	46	52	4	1.11	1.08	1.38	1.3	1.25
32	78	2	30	42	6	56	60	6	1.82	1.77	2.03	1.91	1.81
40	88	3	32	45	7	64	70	6	2.08	2.02	2.35	2.15	2.06
50	102	3	34	48	8	75	84	6	2.73	2.65	3.20	2.85	2.74
65	122	3	38	52	10	90	104	6	3.48	3.36	4.29	3.68	3.65
80	138	3	40	58	12	105	118	8	4.32	4.18	5.54	4.78	4.59
100	162	3	44	65	12	134	145	8	6.07	5.87	7.60	6.46	6.1
125	188	3	48	68	12	162	170	8	8.19	7.95	10.8	8.86	8.22
150	218	3	52	75	12	192	200	10	10.3	9.97	14.6	11.7	10.6
200	278	3	52	80	16	244	256	10	14.3	13.8	22.5	17.1	14.9
250	335	3	60	88	18	298	310	12	20.1	19.4	33.5	24.3	20.9
300	395	4	67	92	18	352	364	12	26.6	25.5	46.3	31.8	27.3
350	450	4	72	100	20	398	418	12	41.8	40.5	68.1	48.8	45.1
400	505	4	78	110	20	452	472	12	57.6	56.1	89.7	63.3	57.7
450	555	4	84	110	20	500	520	12	69.8	67.8	130	76	69.6
500	615	4	90	125	20	558	580	12	87.0	84.6	159	97	87
600	720	5	100	125	20	660	684	12	127	124	278	121	111
700	820	5	-	129	20	760	-	12	-	-	-	155	-
800	930	5	-	138	22	864	-	12	-	-	-	205	-
900	1030	5	-	148	24	968	-	12	-	-	-	249	-
1000	1140	5	-	160	24	1070	-	16	-	-	-	338	-

EN 1092-1:2007

DIMENSIONS OF PN40 FLANGES

TYPE 01

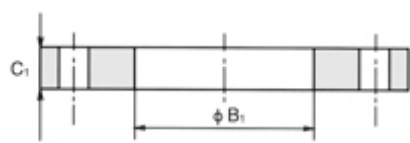

TYPE 02

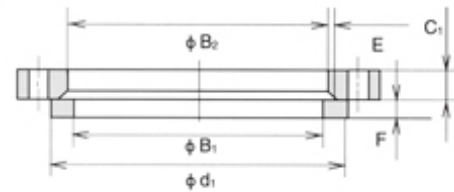

TYPE 05

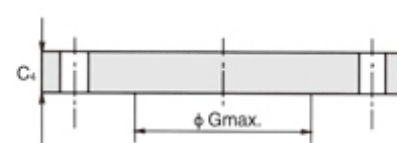

DN	Outside diameter	Diameter of bolt circle	Diameter of bolt hole	Bolt number	Outside diameter of neck A	Bore diameters		Flange thickness			Chamfer E	Wall thickness S	Collar Thickness F	Diameter of shoulder Gmax
						B ₁	B ₂	C ₁	C ₂	C ₄				
						Flange type								
	01,02,05,11,12,13				11	01 12	02	01 02	11 12,13	05	02	11	32	05
10	90	60	14	4	17.2	18.0	21	14	16	16	3	2.0	12	-
15	95	65	14	4	21.3	22.0	25	14	16	16	3	2.0	12	-
20	105	75	14	4	26.9	27.5	31	16	18	18	4	2.3	14	-
25	115	85	14	4	33.7	34.5	38	16	18	18	4	2.6	14	-
32	140	100	18	4	42.4	43.5	47	18	18	18	5	2.6	14	-
40	150	110	18	4	48.3	49.5	53	18	18	18	5	2.6	14	-
50	165	125	18	4	60.3	61.5	65	20	20	20	5	2.9	16	-
65	185	145	18	8	76.1	77.5	81	22	22	22	6	2.9	16	55
80	200	160	18	8	88.9	90.5	94	24	24	24	6	3.2	18	70
100	235	190	22	8	114.3	116.0	120	26	24	24	6	3.6	20	90
125	270	220	26	8	139.7	141.5	145	28	26	26	6	4.0	22	115
150	300	250	26	8	168.3	170.5	174	30	28	28	6	4.5	24	140
200	375	320	30	12	219.1	221.5	226	36	34	36	6	6.3	28	190
250	450	385	33	12	273.0	276.5	281	42	38	38	8	7.1	30	235
300	515	450	33	16	323.9	327.5	333	52	42	42	8	8.0	34	285
350	580	510	36	16	355.6	359.5	365	58	46	46	8	8.8	36	330
400	660	585	39	16	406.4	411.0	416	65	50	50	8	11.0	42	380
450	685	610	39	20	457.0	462.0	467	To be specified by the purchaser	57	57	8	12.5	46	425
500	755	670	42	20	508.0	513.5	519		57	57	8	14.2	50	475
600	890	795	48	20	610.0	616.5	622		72	72	8	16.0	54	575

EN 1092-1:2007

DIMENSIONS OF PN40 FLANGES

TYPE 11

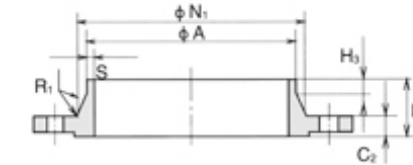

TYPE 12

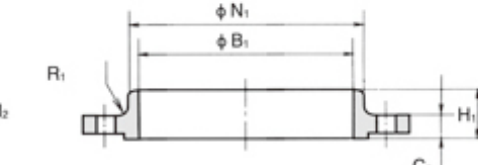

TYPE 13

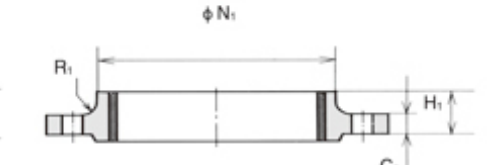

DN	Raised face		Length			Neck diameters		Corner radii	APPROXIMATE WEIGHT				
	d ₁	f ₁	H ₁	H ₂	H ₃	N ₁	N ₂	R ₁					
	Flange type									Type01	Type02	Type05	Type11
	01,05,11,12,13		12 13	11	11	11	12 13	11 12,13					
10	40	2	22	35	6	28	30	4	0.604	0.591	0.722	0.678	0.646
15	45	2	22	38	6	32	35	4	0.67	0.654	0.813	0.768	0.722
20	58	2	26	40	6	40	45	4	0.936	0.909	1.14	1.09	1.04
25	68	2	28	40	6	46	52	4	1.11	1.08	1.38	1.30	1.25
32	78	2	30	42	6	56	60	6	1.82	1.77	2.03	1.91	1.81
40	88	3	32	45	7	64	70	6	2.08	2.02	2.35	2.15	2.06
50	102	3	34	48	8	75	84	6	2.73	2.65	3.20	2.85	2.74
65	122	3	38	52	10	90	104	6	3.48	3.36	4.29	3.68	3.65
80	138	3	40	58	12	105	118	8	4.32	4.18	5.54	4.78	4.59
100	162	3	44	65	12	134	145	8	6.07	5.87	7.60	6.46	6.10
125	188	3	48	68	12	162	170	8	8.19	7.95	10.8	8.86	8.22
150	218	3	52	75	12	192	200	10	10.3	9.97	14.6	11.7	10.6
200	285	3	52	88	16	244	260	10	17.9	17.4	28.8	21.0	18.3
250	345	3	60	105	18	306	312	12	29.3	28.4	44.4	34.2	28.3
300	410	4	67	115	18	362	380	12	45.1	43.6	64.2	47.6	40.4
350	465	4	72	125	20	408	424	12	66.7	64.9	89.5	69.3	58.8
400	535	4	78	135	20	462	478	12	97.1	95.1	127	98	82.1
450	560	4	84	135	20	500	522	12	-	-	154	105	86.2
500	615	4	90	140	20	562	576	12	-	-	188	130	105
600	735	5	100	150	20	666	686	12	-	-	331	209	172